



CAR FILLING



DISPENSERS



PUMPS



METERS



NOZZLE METERS



NOZZLES

SUZZARABLUE PORTABLE KIT

FEATURES

- **READY TO USE**
- **TRANSPORTABLE**
- **CLAMPS FOR BATTERY CONNECTION**

Ease of use is the main feature of the PIUSI Suzzarablue Portable Kit. The basic version of all Adblue® dispensers: it is composed by the Suzzarablue pump and manual nozzle.

PERFORMANCE

UP TO

35 L/MIN

FLOW RATE

AC/DC

VOLTAGE

POWER

20 MIN

DUTY CYCLE



SUZZARABLUE PORTABLE KIT



PACKAGING

CODE	WEIGHT		PACKAGING		N. BOXES / EUROPALLET	
	KG	LBS	MM	PCS/BOX		
FOO201AAA	8	17,6	357X327X275	1	24	36
FOO201C7A	10	22	357X327X275	1	24	36



FILTRATION



FLUID MONITORING



HOSE REELS



ACCESSORIES



MERCHANDISE



AIR



ANTIFREEZE



AdBlue®



BIODIESEL



DIESEL



FOOD



GASOLINE



GREASE



KEROSENE



OIL



WATER



WINDSCREEN

CHARTS

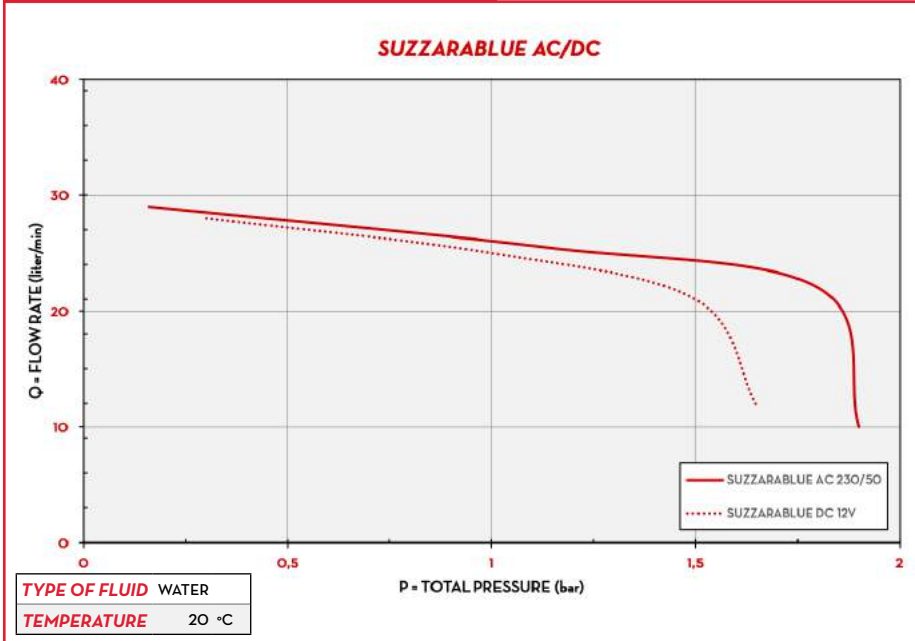

IN THE BOX

- SUZZARBLUE PUMP
- MANUAL NOZZLE
- FOOT VALVE
- INSTRUCTION MANUAL

DETAILS



CLAMPS



FOOT VALVE



MANUAL NOZZLE

DIMENSIONS

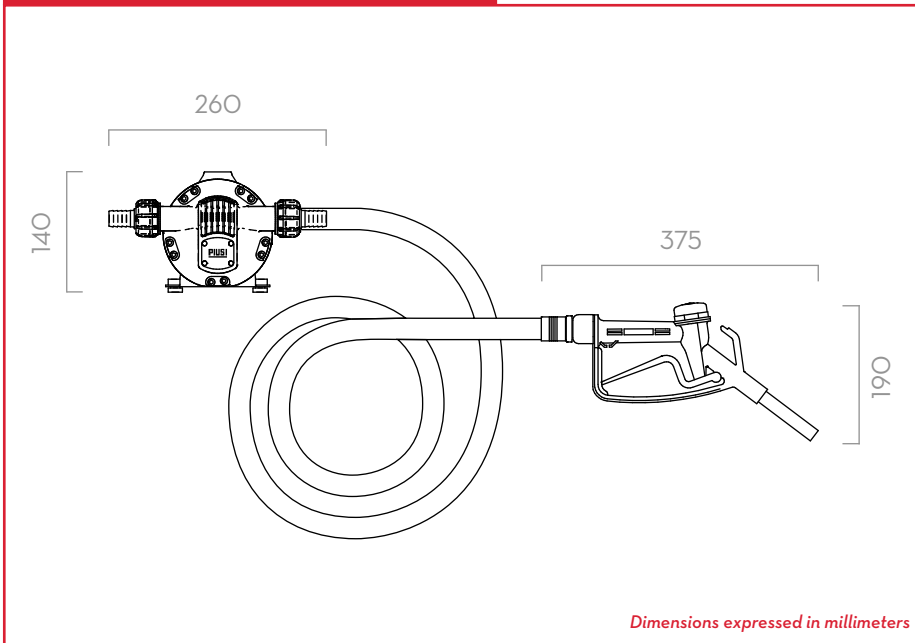

MATERIALS

- **PUMP:**
SUZZARBLUE PUMP DC PAG. 44
- **NOZZLE:**
SUZZARBLUE MANUAL NOZZLE PAG. 88

TECHNICAL DATA

CODE	DESCRIPTION	FLUIDS TYPE	FLOW-RATE		VOLTAGE			NOZZLE TYPE	HOSE		ON/OFF SWITCH
			L/MIN	GPM	AC V/HZ DC VOLT	POWER WATT	AMP. MAX.		LENGHT	Ø	
FOO201AAA	SUZZARBLUE KIT 12V		35	9,2	12	260	22	MANUAL	6 M	3/4"	YES
FOO201C7A	SUZZARBLUE KIT 230 V		32	8,5	230/50	400	1,95	MANUAL	6 M	3/4"	YES

SUZZARBLUE PORTABLE KIT